

## 1. Product features

- All components shall be disassembled for easy replacement. Cold and hot water tank can be cleaned, except bacteria, scale, real safety and beauty.
- Use the cold and hot water tank to separate the cold and hot fog channels.
- The imported components shall be used without attenuation or loss of fogging film, and the atomization time can reach 8000 hours.
- The hot ejection heat pipe shall be made of high quality stainless steel pipe and never be embroidered.
- Water level detection is used for water without water, which ensures automatic power failure without water.
- Sufficient cold fog and heat mist can be used in the same time.
- Novel design, elegant and elegant, easy to operate.

## 2. Main technical indicators of the product

The rated voltage	220V-/50Hz~60Hz	Rated power	800W
Thermal spray safe volume	680ml	Thermal spraying time	30min
Safe volume of cold water tank	600ml	Aerosolized amount	0~400ml

## 3. Install the use steps (see figure)

- take out the metal feet again, and castor, aim the four castor respectively on the feet and nails, make an effort to pressure, at the sound of a pa, castor is installed, the caster and feet together, then as shown in figure 1:
- Fasten the two halves of metal feet together, as shown in figure 2:
- Insert the plastic fork into the metal foot, as shown in figure 3: insert the lifting rod into the plastic and center hole, as shown in figure 4:
- Pass the long screw through the center hole of the concave west plastic film, align the bottom screw of the lifting rod and tighten it with the hand, as shown in figure 5: insert the lifting platform rod into the large rod to tighten the black joint ring, as shown in figure 6:
- Take out the host and place the host on the base, as shown in figure 7:
- Open the cold water inlet and fill the cold water tank with tap water or distilled water to the water level below the maximum water level; Open the hot water inlet and fill the hot water cup with tap water.
- insert the plug of the power supply socket, turn on the switch, the cold spraying work immediately, if the cold spray indicator light is not bright, said the water level is not enough, please continue to cold water tank with water, can be more than the highest water level meters line 10 mm, thermal spray water boiled to begin to work, if the instrument sing doesn't work, please to add a little salt to boot using hot water cup, (because the new too clean undetectable levels, old machine does not exist) as shown in figure 10:

## Install the use step diagram



(figure 1)



(figure 3)

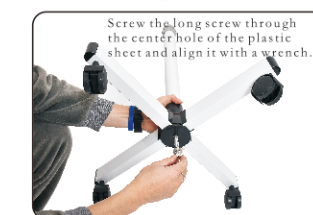

(figure 5)



(figure 7)



(figure 9)



(figure 2)



(figure 4)

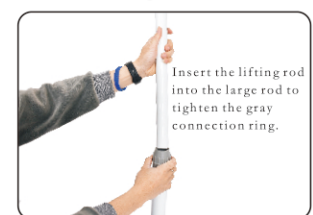

(figure 6)



(figure 8)

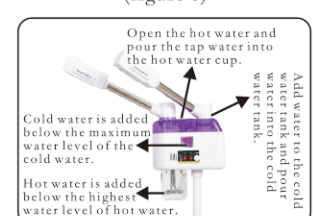

(figure 10)

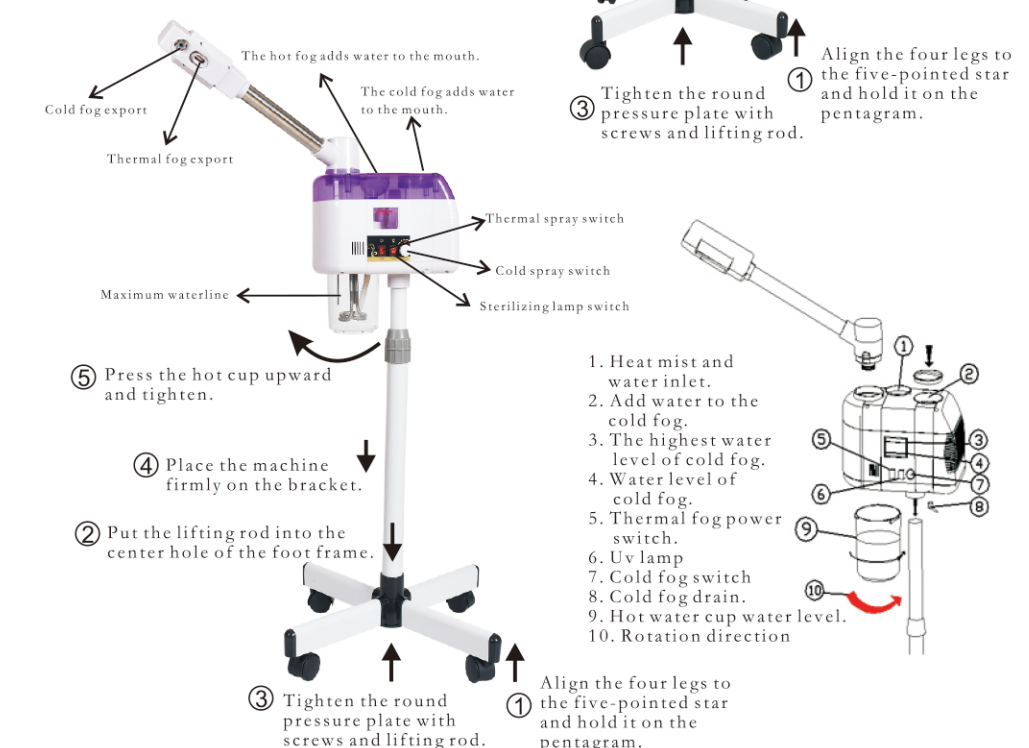
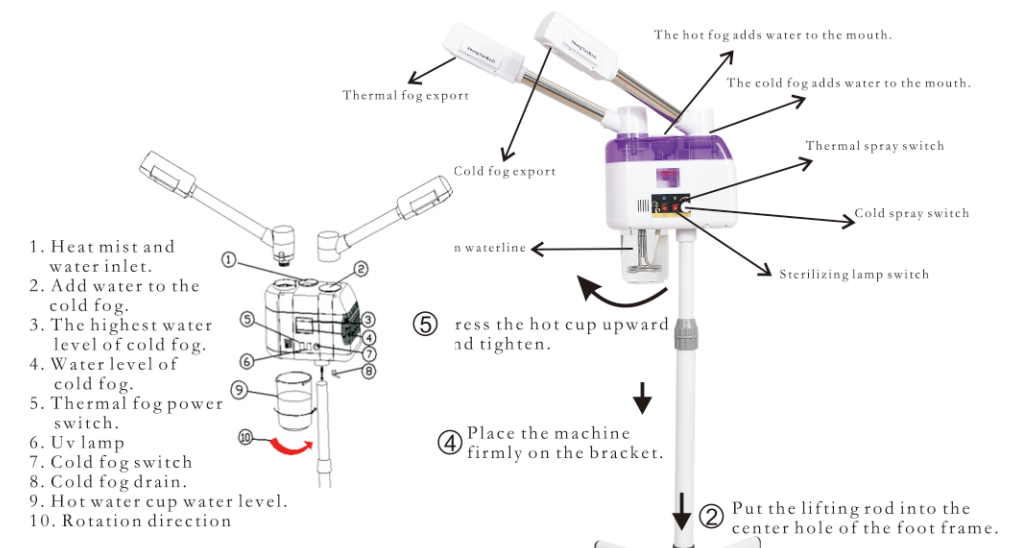

## 4. precautions

- when using do not inverted, tilt instruments, hot and cold fog is not allowed in the running water shortage, not flush device, hot and cold water tank often should change water cleaning, changing water before must unplug the power line plug, please put off all the water when not in use for a long time.
- Attention should be made to determine the time required for the spray and the distance of the mist according to the skin type.

Skin type	distance	time
Oily skin, poor circulation.	25 cm	About 15 minutes
Normal skin	30cm	About 10 minutes to 20 minutes.
Sensitive skin, dry skin.	35cm	5 minutes

- Note: do not add Chinese herbal medicine and essence to the water tank directly. This will cause water spray hazard.
- This product design is applicable to barbershop, beauty salon or similar places.
- Clean to avoid grease and other residual accumulation after use.
- Use tap water for hot spraying. If distilled water is used, the water level will not be detected. They can't work.
- Use distilled water for cold spraying, and avoid fouling of water tank.
- cold water tank cleaning, please add a half cup of white vinegar soak and boot, scale removal soon, remember to use detergent cleaning or washing powder, instrument, once in contact to detergent and washing powder will damage the instrument.

## 5. Repair items

This kind of device has passed strict debugging and inspection before delivery. If there is a malfunction in the use process, please send it to the professional for maintenance. The professional who is not recognized by the enterprise shall not disassemble the instrument, and the enterprise shall not be responsible for the quality matters arising therefrom.

## 6. Common failure analysis

		The cause of the problem	The solution
Cold fog part	Wireless fog motor wind	The cold fog indicator is not on.	Add water to the starting line and turn on the cold fog switch.
		The cold fog indicates the light and the amount of fog is too small.	Adjust the fogging knob.
		Atomizing film aging	Replace the atomizer
		Water quality is too hard	Add food to 10- 20 drops or change water.
		The water is greasy and soapy water.	Clean water tank, add vinegar drop.
Hot spray part	Unheated ring fans	Damage of fan	Replace the fan
		The water level is too high to plug the outlet.	Release the water from the tank to the highest water level.
		Water level is too low	Add water to the starting line.
		Water is so pure	In tap water
		The water level is too high	Drain part of the water below the maximum water level.
Unheated fans	Unheated fans	The water is too dirty and the water is too cloudy.	Clean water cups and clean water.
		Too much oil on the base of the heat pipe is too heavy.(old machine)	Clean water bag cover, that is, heat pipe root.
		The indicator light is not on and the switch is not turned on.	Turn on the switch
		The time is too short for the water to boil.	Wait 5 minutes, boil water in a water cup.
		Heat pipe or temperature insurance is damaged.	Replace heating tube or temperature insurance.

## 7. Warranty card

The user name	Contact phone number	models	
Contact address		The cost of time	
The date of	The cause of the problem	Change the yuan (parts)	Maintenance man The user signature

Finished product inspector: \_\_\_\_\_

The power supply of this instrument is "Y" type connection, not professional person can not fold this instrument! When the power cord of this instrument is damaged, it must be replaced by professionals!

# Cold and heat sprayer

## Operating instruction



Please read this manual carefully before using the machine! Technical changes are subject to change without notice!